

2 sovrum Lägenhet till salu i San Pedro del Pinatar, Murcia

267.000€

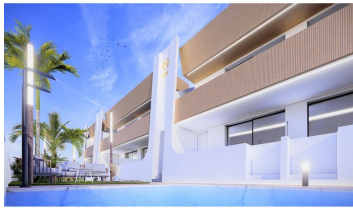



We like to present to you a FULLY EQUIPPED apartment located in San Pedro del Pinatar, just 300 meters from the best beaches of the Mar Menor and the Mediterranean Sea. All amenities can be reached within 2 minutes' walk. The complex consists of 12 apartments with 2 bedrooms and 2 bathrooms. You can either select a ground floor apartment with a private garden or a penthouse apartment with a private solarium from where you can enjoy the views of the surrounding area. Each apartment is divided into a spacious living room, combining the lounge, kitchen and dining area. The large windows open onto a spacious terrace where you can enjoy the Spanish lifestyle. All apartments include all internal and external LED lighting, installed air conditioning, underfloor heating in bathroom, fitted kitchen with induction hob, oven, dishwasher, full furniture package and underground garage parking. The community offers a communal pool and a relax area.

It is possible to purchase a storage room as an option.

San Pedro del Pintar is a place where you have it all. In just a few minutes you will find all kind of amenities and it only takes a few minutes to reach the beach. You can reach the golf course of Lo Romeo Golf in just 15 minutes and the airport of Murcia is only 25 minutes away.

Interested? Do not hesitate and contact us. We are happy to help you further.

- | | | |
|---|--|---|
|  2 sovrum |  2 badrum |  63m ² Bygg storlek |
| <input checked="" type="checkbox"/> Simbassäng | <input checked="" type="checkbox"/> Pool | <input checked="" type="checkbox"/> Communal pool |
| <input checked="" type="checkbox"/> Parking | <input checked="" type="checkbox"/> Underground parking | <input checked="" type="checkbox"/> Lift |
| <input checked="" type="checkbox"/> Close to sea | <input checked="" type="checkbox"/> Close to shops | <input checked="" type="checkbox"/> Close to supermarkets |
| <input checked="" type="checkbox"/> Close to restaurants | <input checked="" type="checkbox"/> Fitted wardrobes | <input checked="" type="checkbox"/> Fitted kitchen |
| <input checked="" type="checkbox"/> Open plan kitchen | <input checked="" type="checkbox"/> Fitted bathroom | <input checked="" type="checkbox"/> Air conditioning |
| <input checked="" type="checkbox"/> Communal garden | <input checked="" type="checkbox"/> Private terrace | <input checked="" type="checkbox"/> Gated complex |
| <input checked="" type="checkbox"/> Electric blinds | <input checked="" type="checkbox"/> Reinforced door | <input checked="" type="checkbox"/> Furnished |