

2 sovrum Lägenhet till salu i Benalmadena Pueblo, Málaga

599.000€

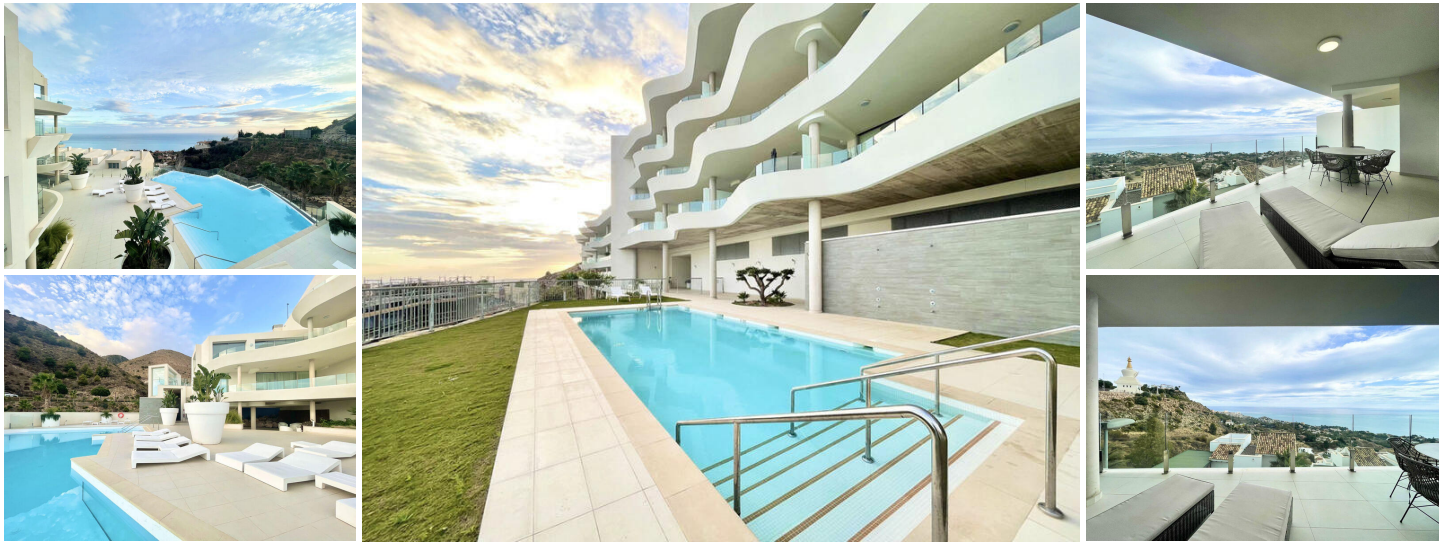

Middle Floor Apartment, Benalmadena Pueblo, Costa del Sol.

2 Bedrooms, 2 Bathrooms, Built 100 m², Terrace 37 m².

This stunning property close to the Stupa in Benalmadena is now for sale.

Very spacious and bright, consists of 2 bedrooms & 2 bathrooms, open plan kitchen, a lovely livingroom, a big terrace and the most amazing panoramic sea view.

2 parking spaces & 1 storage room is included in the price.

The complex is gated and you have the most amazing common areas inside the gates; Several community pool areas, infinity pool, indoor pool, steam bath, sauna, gym & much more.

Everything is also very close to the complex; Town, restaurants, shops & with easy access to the highway.

This is a must - see property. Contact us today for a viewing - We have the key

Setting : Town, Close To Golf, Close To Shops, Close To Town, Close To Schools, Urbanisation.

Orientation : South.

Condition : Excellent.

Pool : Communal, Indoor.

Climate Control : Air Conditioning, Hot A/C, Cold A/C.

Views : Sea, Mountain, Panoramic, Urban.

Features : Covered Terrace, Lift, Fitted Wardrobes, Near Transport, Private Terrace, WiFi, Gym, Sauna, Storage Room, Utility Room, Ensuite Bathroom, Double Glazing, Domotics.

Furniture : Not Furnished.

Kitchen : Fully Fitted

- | | | |
|---|--|--|
|  2 sovrum |  2 badrum |  100m ² Bygg storlek |
| <input checked="" type="checkbox"/> Simbassäng | <input checked="" type="checkbox"/> Setting - Town | <input checked="" type="checkbox"/> Setting - Close To Golf |
| <input checked="" type="checkbox"/> Setting - Close To Shops | <input checked="" type="checkbox"/> Setting - Close To Town | <input checked="" type="checkbox"/> Setting - Close To Schools |
| <input checked="" type="checkbox"/> Setting - Urbanisation | <input checked="" type="checkbox"/> Orientation - South | <input checked="" type="checkbox"/> Condition - Excellent |
| <input checked="" type="checkbox"/> Pool - Communal | <input checked="" type="checkbox"/> Pool - Indoor | <input checked="" type="checkbox"/> Climate Control - Air Conditioning |
| <input checked="" type="checkbox"/> Climate Control - Hot A/C | <input checked="" type="checkbox"/> Climate Control - Cold A/C | <input checked="" type="checkbox"/> Views - Sea |
| <input checked="" type="checkbox"/> Views - Mountain | <input checked="" type="checkbox"/> Views - Panoramic | <input checked="" type="checkbox"/> Views - Urban |
| <input checked="" type="checkbox"/> Features - Covered Terrace | <input checked="" type="checkbox"/> Features - Lift | <input checked="" type="checkbox"/> Features - Fitted Wardrobes |