

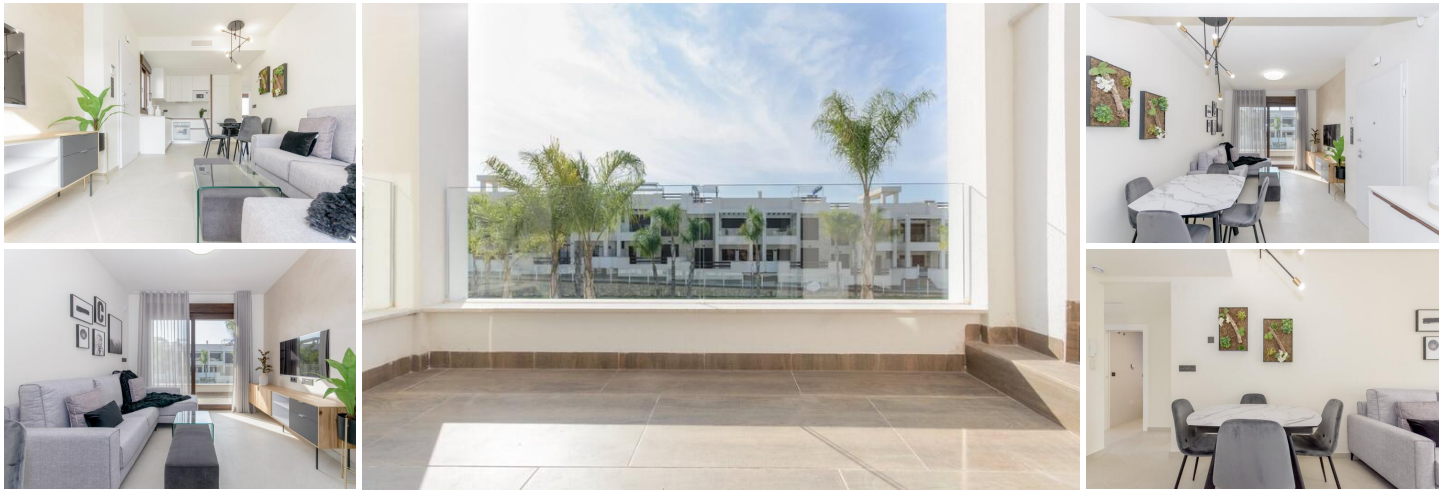



3 спальная комната городская тюрма продается в Torrevieja, Alicante

335.000€



NEW BUILD RESIDENTIAL OF BUNGALOW APARTMENTS IN LOS BALCONES, TORREVIEJA; New Build residential complex with magnificent pink salt lake views in Los Balcones. Complex consist of 104 bungalow apartments with 2 and 3 bedrooms, top floor bungalow has private solariums with panoramic views to the salt lake and ground floors bungalows have big terraces overlooking the green area. These bungalows share beautiful green areas and 2 large swimming pools. Optional underground parking and storage spaces are available. This residential offers modern design, selected materials, apartments finished to very highest specification using only top quality materials. The Residential will be built up to a hillside, in this way the view and also the air is clear and unique quality. Los Balcones located just outside Torrevieja with all accessible services, just 5 minutes from Playa de Los Náufragos, supermarkets, the school and the La Zenia Boulevard Shopping Centre, and a minute from Torrevieja University Hospital. Furthermore you will find 4 golf courses within a short drive, including the award winning Las Colinas Golf & Country Club. Complex located 40 minutes from Alicante airport and 1 hour Murcia - Corvera airport;

- | | | |
|--|--|--|
|  3 спальни |  2 ванные комнаты |  70m ² Размер сборки |
| <input checked="" type="checkbox"/> Communal Pool | <input checked="" type="checkbox"/> Gated | <input checked="" type="checkbox"/> Near Schools |
| <input checked="" type="checkbox"/> Near Bus Route | <input checked="" type="checkbox"/> Location: Coastal, Urbanisation | <input checked="" type="checkbox"/> Air Conditioning: Pre-Installed |
| <input checked="" type="checkbox"/> Double Bedrooms: 3 | <input checked="" type="checkbox"/> Near Trees | <input checked="" type="checkbox"/> Beach: 3500 Meters |
| <input checked="" type="checkbox"/> Key Ready | <input checked="" type="checkbox"/> Useable Build Space: 60 Msq. | <input checked="" type="checkbox"/> Terrace: 64 Msq. |
| <input checked="" type="checkbox"/> Parking - Space | | |