

3 спальная комната городская тюрьма продается в Orihuela Costa, Alicante

370.500€

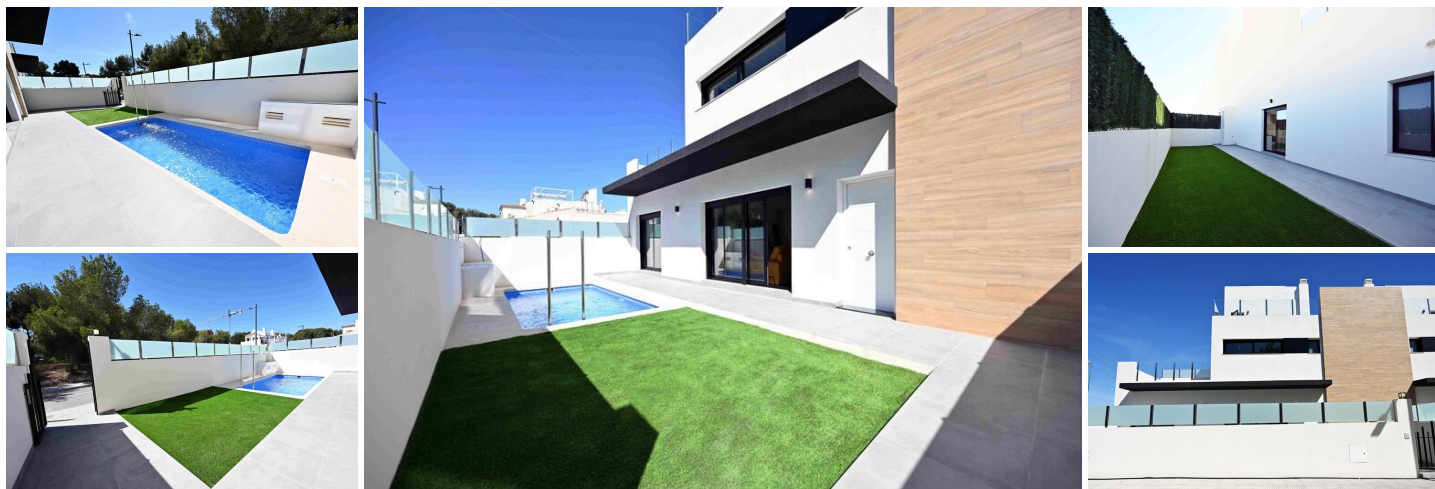

NEW BUILD TOWNHOUSE IN LAS FILIPINAS, ORIHUELA COSTA - with private pool and garden!

Located on a complex of 12 other properties this wonderful 97m² townhouse consists of 3 bedrooms and 2 bathrooms, on the ground floor there is a bright living room with an open-plan kitchen, a spacious bedroom with built-in wardrobe and a bathroom.





On the first floor there is a second large bedroom with built-in wardrobe and a bathroom. From the bedroom there is an exit to a sunny balcony with space for terrace furniture.

Upstairs you have the roof terrace is your outdoor kitchen, jacuzzi and chill-out area complete with shower.

Included in the price is; pre-installed ducted A/C, fitted bathrooms including shower screens, aerothermic hot water system heater, kitchen units (NO WHITE GOODS), intercom, LED lighting package (indoor & outdoor), electric shutters, outdoor kitchen, artificial grass, swimming pool (5.5 x 2.5 m) and parking space.

The development is located near three popular golf courses (Villamartin, Las Ramblas and Campoamor), just five minutes from the best beaches of Orihuela Costa.

Within a few minutes' walk you will find all services such as bars, restaurants and shops, La Fuente shopping center.

- | | | |
|---|--|--|
|  3 спальни |  2 ванные комнаты |  97m ² Размер сборки |
|  178m ² Размер участка | <input checked="" type="checkbox"/> Бассейн | <input checked="" type="checkbox"/> Panoramic views |
| <input checked="" type="checkbox"/> Garden | <input checked="" type="checkbox"/> Gated complex | <input checked="" type="checkbox"/> Air conditioning |
| <input checked="" type="checkbox"/> Private pool | <input checked="" type="checkbox"/> Parking | <input checked="" type="checkbox"/> Near beach |
| <input checked="" type="checkbox"/> Close to airport | <input checked="" type="checkbox"/> Close to golf | <input checked="" type="checkbox"/> Close to schools |
| <input checked="" type="checkbox"/> Close to shops | <input checked="" type="checkbox"/> Coastal, Popular urbanisation | <input checked="" type="checkbox"/> Roof terrace |