

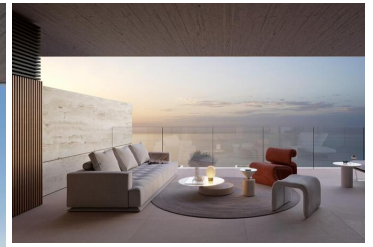

## 2 спальная комната квартира продается в Manilva, Málaga

925.000€

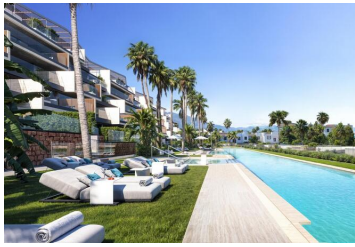

Luxurious Beachfront Residences in Manilva: your Oasis on the Costa del Sol.

### Overview of Exclusive Residences.





This prestigious beachfront development in Manilva offers a range of luxury homes: 66 two, three, and four-bedroom apartments, spacious three and four-bedroom penthouses, and five elegant bungalows. Located just 100 meters from the beach, each home is designed with expansive terraces to capture panoramic views of the Mediterranean Sea, providing a serene and luxurious lifestyle.

### Prime Location with Easy Access to Estepona and Sotogrande.

Situated on the shores of the Mediterranean, this development places you in a prime location near Estepona, known as the "jewel of the Costa del Sol," and Sotogrande, famous for its marina and polo fields. Manilva's tranquility allows residents to enjoy the calm of the sea while remaining close to vibrant destinations. Marbella, Gibraltar, and Tarifa are easily accessible, and Malaga Airport, Gibraltar Airport, and Jerez Airport are each under an hour's drive away, providing convenient travel options.

### Impressive Amenities for a Unique Living Experience.

This development offers a wealth of exclusive amenities. It includes a fully equipped fitness center with sea views, an infinity pool, a children's saltwater pool, and landscaped gardens spanning over 5,000 m<sup>2</sup>, plus an additional 13,500 m<sup>2</sup> public green area. These lush, landscaped areas create a natural and relaxing environment, offering pathways

- |   |   |   |
|---|---|---|
|  2 спальни                        |  2 ванные комнаты                    |  107m <sup>2</sup> Размер сборки |
|  Communal Pool                    |  Gated                               |  Number of Parking Spaces: 1     |
|  Views: Sea                       |  Near Schools                        |  Near Commercial Center          |
|  Near Bus Route                   |  Location: Coastal, Urbanisation     |  Elevator/Lift                   |
|  Near Golf / Golf Resort Property |  Double Bedrooms: 2                  |  Near Trees                      |
|  Gym                              |  Heating: Yes, Air Conditioning: Yes |  Useable Build Space: 75 Msq.    |
|  First Line to the Sea            |  Beach: 100 Meters                   |  Terrace: 46 Msq.                |
|  Parking - Space                  |   |   |

