

3 спальная комната квартира продается в Estepona, Málaga

539.000€

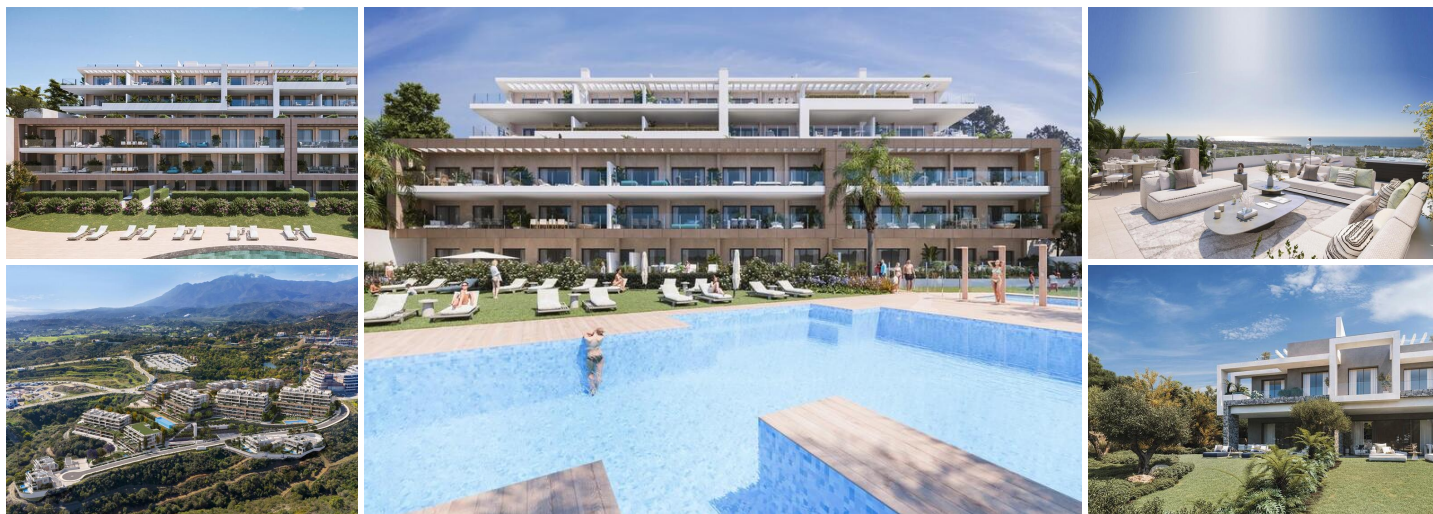



New off-plan project in Selwo with spectacular sea views.

Discover a privileged environment in this new off-plan project, surrounded by nature and located very close to Selwo Park, with privileged views of the Mediterranean. Perfectly connected, just minutes from the sea and the urban centers of Estepona and Cancelada, and only 18 km from Marbella, this development offers a unique opportunity to live on the Costa del Sol.

The development will feature a variety of properties including 2, 3, and 4-bedroom apartments and penthouses, as well as 8 semi-detached 3-bedroom villas, designed to suit various lifestyles and family needs.

Enjoy magnificent communal areas designed for entertainment and well-being, including several pools (adult, children's, and heated), 2 jacuzzis, a paddle tennis court, a fully equipped gym, a coworking space, a spa for relaxation, a multi-purpose room, and extensive green areas with paths and fountains.

Immerse yourself in a lifestyle of luxury and comfort in this exceptional enclave on the Costa del Sol. Don't miss the opportunity to be part of this exciting project. Contact us today for more information and to reserve your new residence in this magnificent complex!

- | | | |
|--|--|---|
|  3 спальни |  2 ванные комнаты |  168m ² Размер сборки |
| <input checked="" type="checkbox"/> Бассейн | <input checked="" type="checkbox"/> a estrenar | <input checked="" type="checkbox"/> aire acondicionado |
| <input checked="" type="checkbox"/> amueblado | <input checked="" type="checkbox"/> apartamento | <input checked="" type="checkbox"/> armarios empotrados |
| <input checked="" type="checkbox"/> ascensor | <input checked="" type="checkbox"/> calefacción central | <input checked="" type="checkbox"/> cocina amueblada |
| <input checked="" type="checkbox"/> cocina equipada | <input checked="" type="checkbox"/> condominio | <input checked="" type="checkbox"/> edificio con garaje |
| <input checked="" type="checkbox"/> exterior | <input checked="" type="checkbox"/> gimnasio | <input checked="" type="checkbox"/> jardín comunitario |
| <input checked="" type="checkbox"/> lavadero | <input checked="" type="checkbox"/> obra nueva | <input checked="" type="checkbox"/> parking |
| <input checked="" type="checkbox"/> piscina | <input checked="" type="checkbox"/> piscina comunitaria | <input checked="" type="checkbox"/> plaza garaje incluida |