

## 4 спальная комната вила продается в Altea, Alicante

1.900.000€

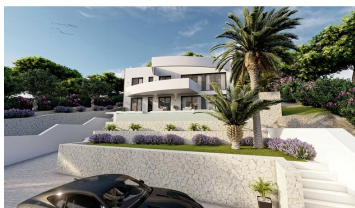

New luxury villa located in Sierra de Altea, a very prestigious residential area with exceptional sea and mountain views, just a few minutes from the town of Altea la Vella, and 10 minutes by car from the city of Altea with proximity of amenities and well connected with surrounding cities and airports via the AP-7 motorway.

The property is currently under construction, so there is the possibility of being able to personalise it to your taste. The villa is built on a plot of 1,270m<sup>2</sup> with a total constructed area of 500m<sup>2</sup>, distributed over 3 floors.

On the ground floor there is a large open plan kitchen, a spacious and bright living-dining room, a good sized bedroom en suite, a toilet and a laundry room. On the same floor and in the outdoor area, there is an infinity swimming pool, a chill out area and a magnificent terrace to enjoy the Mediterranean sun and beautiful panoramic sea views. Going up the stairs or the lift, we reach the upper floor, which houses the master bedroom en suite with its dressing room of more than 11m<sup>2</sup> and 2 more bedrooms en suite. On the basement floor there is a huge garage for several vehicles which can be accessed by an automatic door or by the lift.

The villa has other first class extras: a solarium of 135m<sup>2</sup>, outdoor parking for 2 cars, Mediterranean garden with automatic irrigation system, centralised air conditioning and heating system, alarm and video surveillance system, home automation with anti-sabotage protection, LED lighting, luxury appliances and bathroom furniture, underfloor heating and Jacuzzi.

Interested? Do not hesitate and contact our office. We will be happy to help you.

- |   |  |   |
|---|--|---|
|  4 спальни                          |  5 ванные комнаты |  500m <sup>2</sup> Размер сборки |
|  1.270m <sup>2</sup> Размер участка | <input checked="" type="checkbox"/> Бассейн  | <input checked="" type="checkbox"/> Pool  |
| <input checked="" type="checkbox"/> Private pool  | <input checked="" type="checkbox"/> Garage   | <input checked="" type="checkbox"/> Parking   |
| <input checked="" type="checkbox"/> Private parking   | <input checked="" type="checkbox"/> Lift   | <input checked="" type="checkbox"/> Close to sea  |
| <input checked="" type="checkbox"/> Close to shops  | <input checked="" type="checkbox"/> Close to golf  | <input checked="" type="checkbox"/> Close to supermarkets   |
| <input checked="" type="checkbox"/> Close to restaurants  | <input checked="" type="checkbox"/> Basement   | <input checked="" type="checkbox"/> Fitted wardrobes  |
| <input checked="" type="checkbox"/> Open plan kitchen   | <input checked="" type="checkbox"/> Air conditioning   | <input checked="" type="checkbox"/> Enclosed Plot   |
| <input checked="" type="checkbox"/> Private garden  | <input checked="" type="checkbox"/> Various terraces   | <input checked="" type="checkbox"/> Private terrace   |