

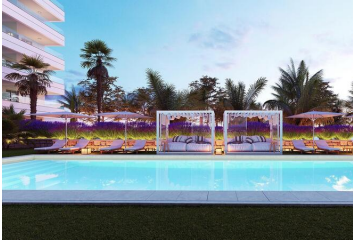

## 2 спальная комната квартира продается в Marbella, Málaga 285.390€



NEW BUILD RESIDENTIAL COMPLEX NEAR MARBELLA New Build residential complex of apartments with 2 and 3 bedrooms in Nueva Andalucia, near Marbella. Spaces created for your well-being, harmonious materials, comforting light coming through the windows and that feeling of quality in every corner. Everything has been thought of here with a single purpose: to make you feel great. Option of kitchen open to the living room or closed kitchen\*, with high and low furniture of great capacity, finished in white with handle, Silestone worktop or similar. The main bathroom has a toilet, porcelain shower and suspended washbasin. The floors will be made with laminate flooring. Kitchen and bathroom floors will be made with top quality stoneware. The whole house will have a false ceiling, which will provide greater thermal and acoustic comfort, as well as facilitating the installation of lighting, light fittings and all kinds of modifications that need to be made to the ceiling. Residential complex offering you different housing alternatives, designed to suit your needs. It is time to choose. Nueva Andalucia is a well thought out and attractive area just west of Marbella where, as its name suggests, the villas and apartments are based on traditional Andalusian architecture and design. Nueva Andalucía is the largest neighbourhood in Marbella, extending over several square kilometres. The key attractions today are the large residential estate, reasonable access to the highway and Marbella and, for many, a short taxi ride home from the Puerto Banús nightlife. Being a large residential area it has plenty of small commercial centres and restaurants for those who don't want to venture out on a rainy or sunny day.

- |   |   |  |
|---|---|--|
| 2 спальни   | 2 ванные комнаты  | 79m <sup>2</sup> Размер сборки                                   |
| <input checked="" type="checkbox"/> Communal Pool                   | <input checked="" type="checkbox"/> Gated                           | <input checked="" type="checkbox"/> Number of Parking Spaces: 1  |
| <input checked="" type="checkbox"/> Near Schools                    | <input checked="" type="checkbox"/> Near Commercial Center          | <input checked="" type="checkbox"/> Near Bus Route               |
| <input checked="" type="checkbox"/> Location: Coastal, Urbanisation | <input checked="" type="checkbox"/> Air Conditioning: Pre-Installed | <input checked="" type="checkbox"/> Elevator/Lift                |
| <input checked="" type="checkbox"/> Double Bedrooms: 2              | <input checked="" type="checkbox"/> Beach: 2500 Meters              | <input checked="" type="checkbox"/> Useable Build Space: 70 Msq. |
| <input checked="" type="checkbox"/> Terrace: 27 Msq.                |   |  |

