

3 bedroom Villa for sale in San Pedro del Pinatar, Murcia

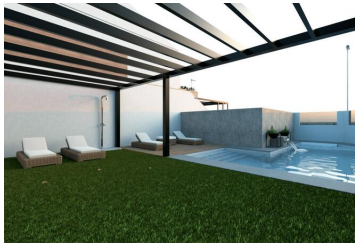

264,900€



OUTDOOR AREAS Luxury flats distributed in penthouses with solariums and ground floors with terraces. Enjoy each flat with 2 bedrooms and 2 furnished bathrooms. New perspective of life contemplating open rooms with lots of light and space. The area is very quiet and safe, services and unique features to attract the most demanding. Endless Horizon unites the Mediterranean with your new home to bring you unforgettable moments and experiences to share with family and friends.

INDOOR AREAS The homes have a set of details with the best finishes and a design by an author with great talent. They are equipped so that no need is left unsatisfied, underfloor heating in the bathrooms which are furnished, fitted kitchen with appliances included, efficient water consumption system, in short a host of features that Endless Horizon offers to make it a great choice both to live in the residential and to opt for an investment.

SAN PEDRO DEL PINATAR San Pedro del Pinatar, in the region of Murcia, is known for its natural park, the Salinas y Arenales de San Pedro. This coastal destination attracts tourists for its long beaches, therapeutic mud waters and biodiversity in the salt flats. Tourism in San Pedro del Pinatar focuses on its beaches, mud therapies and bird watching in the natural park. In addition, its promenade and gastronomic offer are highlights for visitors. The lifestyle in San Pedro del Pinatar is tranquil and linked to the sea. Residents enjoy a relaxed lifestyle, valuing the therapeutic properties of the salt flats and taking part in water activities. San Pedro del Pinatar offers a coastal and natural environment for those looking to enjoy the beach, nature and mud therapies, creating an ideal destination to relax and enjoy the Mar Menor coastline.

- | | | |
|---|---|--|
|  3 bedrooms |  2 bathrooms | <input checked="" type="checkbox"/> Golf |
| <input checked="" type="checkbox"/> Airport distance: 60500m | <input checked="" type="checkbox"/> Hospital | <input checked="" type="checkbox"/> Green areas |
| <input checked="" type="checkbox"/> Near Sea | <input checked="" type="checkbox"/> Built-in cabinets | <input checked="" type="checkbox"/> School |
| <input checked="" type="checkbox"/> Sea distance: 1000m | <input checked="" type="checkbox"/> Kitchen: furnished+appliances | <input checked="" type="checkbox"/> Community garage |