

3 bedroom Villa for sale in Macisvenda, Murcia

179,950€

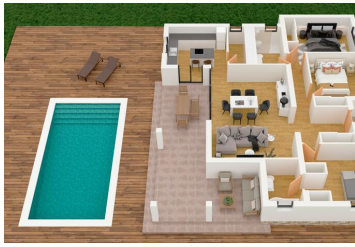

SIERRA Design

The houses that we carry out have a high-class construction, through the use of top quality materials.

HOUSING QUALITY WARRANTY

The identification system of the houses is the names of well-known Spanish authors. The foundation has a warranty (over 10 years) for the construction.

The houses are built with different materials and systems, using the best quality materials.

All the work can be changed at the Client's choice, that is, the division of the rooms can be adapted to the Client's needs.

On the case we will send the Client a report to inform him about the quality of the materials used.

The houses are built with high quality materials, being able to choose different materials and systems for the Client.

All our houses have pre-consideration of an air conditioning system, pre-installation of gas heating and solar panels for the water.

The exterior carpentry is made of PVC and double glass to ensure adequate sound and thermal insulation.

The exterior carpentry is painted wood or in the customer's choice.

If the client wishes, the pool construction of the chosen dimensions can be carried out.

The exterior carpentry of the house adapts to the plot where it is located, preferring everything necessary for good use and enjoyment of it.

All our projects can be adapted to suit the client.



Modelo SIERRA

Las viviendas que realizamos tienen una construcción de alta categoría, mediante utilización de materiales de primera calidad.

MEMORIA DE CALIDADES DE LAS VIVIENDAS

El sistema constructivo de las viviendas se realiza mediante estructura de hormigón armado. Se construyen siempre en bloques independientes entre bloques.

Los grandes ventanales tienen un aislamiento sustancial para proteger a las viviendas una alta cualificación energética.

Nuestro sistema constructivo garantiza un aislamiento acústico de primer nivel, además que se dispone de las viviendas para ser adaptadas a las necesidades del cliente.

En la cubierta se utiliza cerámica impermeable para asegurar un mantenimiento perfecto.

Los acabados interiores de pavimentos y chapados son de alta calidad, seleccionados para ser de primera calidad y a gusto del cliente.

Nuestro sistema constructivo garantiza un aislamiento acústico de primer nivel, además que se dispone de las viviendas para ser adaptadas a las necesidades del cliente.

El sistema constructivo de PVC y doble vidrio para asegurar una adecuada impermeabilización y aislamiento de la vivienda.

La carpintería exterior se realiza en aluminio anodizado.

Se elige el tipo de suelo en función de la construcción de primer nivel de las viviendas.

Se optimizan los costes de la vivienda en relación a la propia obra, en todo momento se garantiza la calidad de la obra y a gusto del cliente.

Nuestro sistema constructivo garantiza un aislamiento acústico de primer nivel, además que se dispone de las viviendas para ser adaptadas a las necesidades del cliente.







"New Villa Off Plan", Style "Sierra".





The price includes construction, project fees of senior architect + technical architect direction, building license from town hall, geotechnical studies and concrete tests. This price does not include the purchase of the land, water and electricity connections. We can build this project in Hondon Valley or any of the surrounding areas. We can also provide the plots for you (we have plots in the area with water and electricity connections, or we can build this as "Off Grid" as well, if you prefer. A swimming pool of 8x4 meters + concrete terrace can be added to the project for an extra cost, also a guest "casita", garage or barbecue can be quoted separately (please ask us for a quote without any compromise). Hondon Valley is a very well located area where you have all services and amenities for your day a day living such as shops, bars, lovely restaurants, doctors, school, gym, etc.

Please, do not hesitate to contact us for further details or to arrange a first meeting with our architect and builder to discuss the project of your "Dream Villa in the Sun".

Living in Macisvenda

Macisvenda is located in the Eastern Region of Murcia, on the border with the Valencian Community. The peculiarity of its semi-desert climate offers a landscape of oasis in which the rambla palm tree stands out haughtily. The source of the river Chicamo gives this municipality some spectacular landscapes that will transport the visitor to film scenes, where he can discover from very arid areas where the loamy lands are capriciously sculpted by erosion, to rich fertile orchards, natural water sources, hundreds of hectares with millenary olive trees and mountains.

-  3 bedrooms
-  5,000m² Plot size
-  Electricity
-  Air conditioner

-  2 bathrooms
-  Garden
-  Laundry
-  Porch

-  156m² Build size
-  Fenced
-  Chimney



Property marketed by Casa Consultants

www.spainpropertyportal.com/