

2 bedroom Apartment for sale in San Pedro del Pinatar, Murcia

179,000€

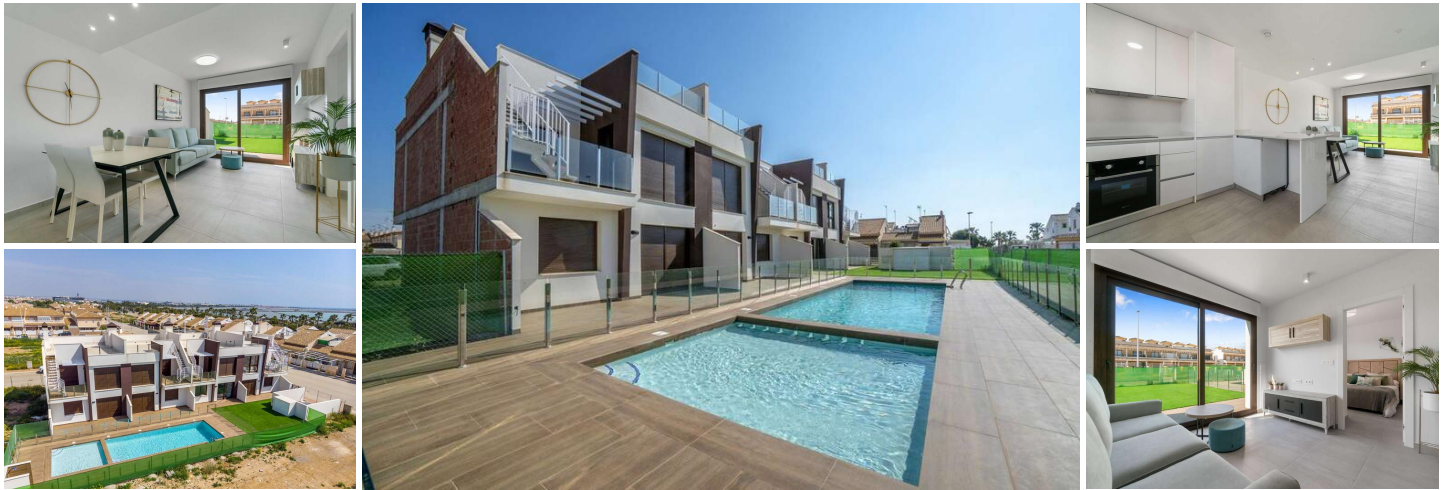



Newly released project in San Pedro del Pinatar, located on Costa Cálida. All the necessary daily services are situated close by, which makes the town the ideal location for all year living and holiday visits.

The complex consists of apartment blocks in two levels, offering apartments on the ground floor with a big terrace, and apartments on the top floor with a private solarium. All apartments include 2 bedrooms and 2 bathrooms, a spacious open-plan lounge, kitchen, and dining area. Both bedrooms have fitted wardrobes, and the master bedroom has an en-suite bathroom. The terrace can be accessed from the lounge and the master bedroom. For the top-floor apartments, the private solarium can be accessed from the terrace.

Each apartment includes pre-installation for AC, and a private parking space. The communal area includes a garden area, and two large pools, with a children's area.

The beautiful beaches of the Mar Menor, and the famous mud-baths, are less than 10 minutes away by car. The area is well connected by road to the main cities of the area, with the Murcia International airport only 30 minutes' drive away.

Interested? Do not hesitate and contact us. We are happy to help you further.

- | | | |
|---|---|---|
|  2 bedrooms |  2 bathrooms |  67m ² Build size |
| <input checked="" type="checkbox"/> Swimming Pool | <input checked="" type="checkbox"/> Pool | <input checked="" type="checkbox"/> Children's pool |
| <input checked="" type="checkbox"/> Communal pool | <input checked="" type="checkbox"/> Parking | <input checked="" type="checkbox"/> Private parking |
| <input checked="" type="checkbox"/> Close to sea | <input checked="" type="checkbox"/> Close to shops | <input checked="" type="checkbox"/> Close to golf |
| <input checked="" type="checkbox"/> Close to supermarkets | <input checked="" type="checkbox"/> Close to restaurants | <input checked="" type="checkbox"/> Fitted wardrobes |
| <input checked="" type="checkbox"/> Fitted kitchen | <input checked="" type="checkbox"/> Open plan kitchen | <input checked="" type="checkbox"/> Fitted bathroom |
| <input checked="" type="checkbox"/> Pre-installed air conditioning | <input checked="" type="checkbox"/> Communal garden | <input checked="" type="checkbox"/> Private terrace |
| <input checked="" type="checkbox"/> Gated complex | <input checked="" type="checkbox"/> Video entry system | <input checked="" type="checkbox"/> Reinforced door |