

2 bedroom Apartment for sale in Estepona, Málaga

349,000€

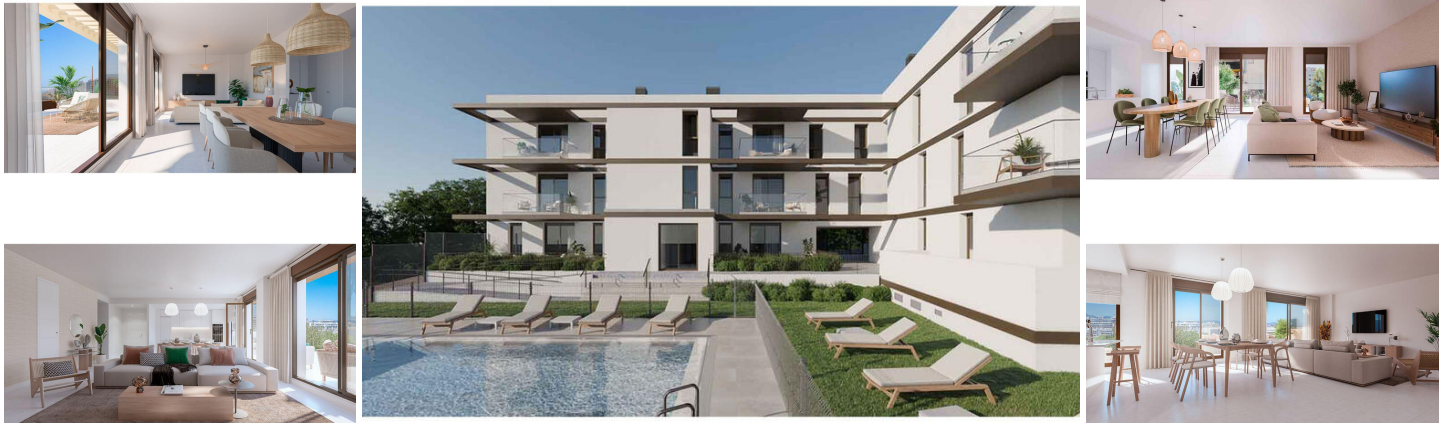





ESTEPONA ... OFF PLAN EXPECTED DATE OF COMPLETION END OF 2025

This residential complex is composed of a total of 84 1-,2-,3- and 4- bedroom apartments distributed in three different residential spaces within a consolidated area only a few minutes from the beach, town centre, and Estepona's Marina. The various apartment orientations mean that you can choose the one which best fits your tastes and needs. All units are designed to make the most of the natural light from their spacious terraces and living rooms. Furthermore, each residential property enjoys the use of shared garden areas and a community swimming pool for the enjoyment of the whole family. The large plot will include a complete gymnasium for the use and enjoyment of the most active members of the family..

Each residential space has pleasant common areas that include gardens and communal pool, being the one located in the middle part which has, in turn, an exceptional indoor pool and a complete gym.

Spacious and perfectly lit rooms with living and dining rooms connected to spacious terraces. Open and diaphanous kitchens, fully equipped with low consumption appliances, according to the criteria of sustainability, practicality and comfort.

- | | | |
|---|---|---|
|  2 bedrooms |  2 bathrooms |  80m ² Build size |
|  10m ² Plot size | <input checked="" type="checkbox"/> Urbanisation | <input checked="" type="checkbox"/> Close To Shops |
| <input checked="" type="checkbox"/> Close To Sea | <input checked="" type="checkbox"/> Close To Town | <input checked="" type="checkbox"/> Close To Schools |
| <input checked="" type="checkbox"/> South East | <input checked="" type="checkbox"/> Excellent | <input checked="" type="checkbox"/> Communal Pool |
| <input checked="" type="checkbox"/> Air Conditioning | <input checked="" type="checkbox"/> Pre Installed A/C | <input checked="" type="checkbox"/> Hot A/C |
| <input checked="" type="checkbox"/> Cold A/C | <input checked="" type="checkbox"/> Mountain | <input checked="" type="checkbox"/> Panoramic |
| <input checked="" type="checkbox"/> Garden | <input checked="" type="checkbox"/> Pool | <input checked="" type="checkbox"/> Urban |
| <input checked="" type="checkbox"/> Country | <input checked="" type="checkbox"/> Covered Terrace | <input checked="" type="checkbox"/> Lift |