

2 bedroom Apartment for sale in Casares, Málaga

320,000€

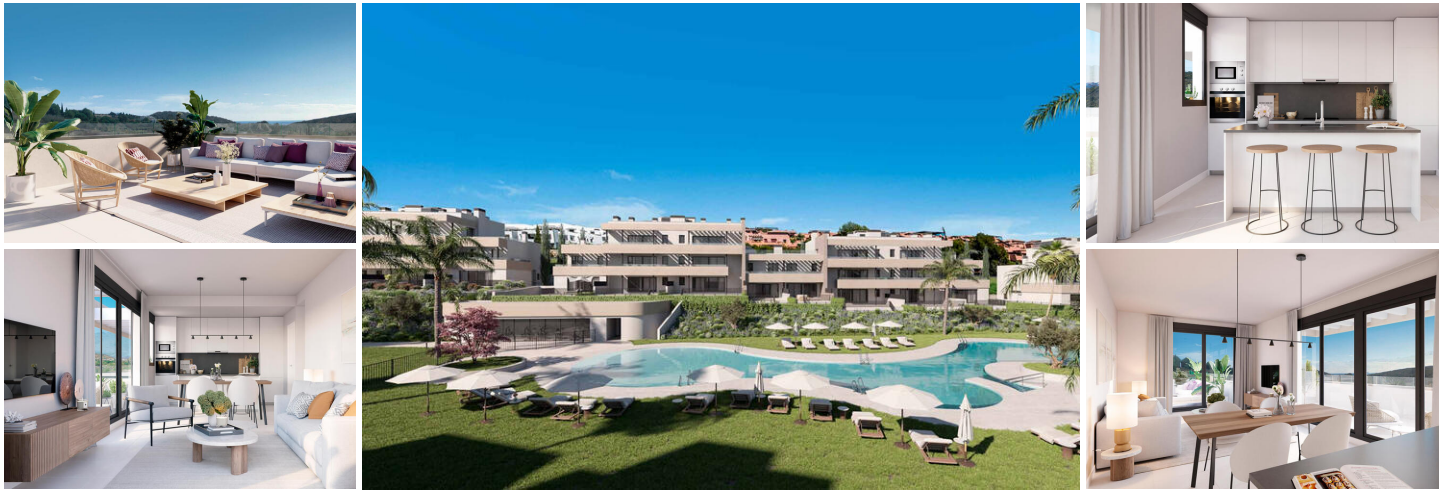

Brand new apartment located in Estepona west, whose avant-garde and modern design blends in with the adjoining golf course.

Its west-southwest orientation provides maximum use of natural light and views that allow you to contemplate the surrounding natural landscape, some with sea views.



The communal areas have been designed with sustainability in mind, including a wide variety of equipment and top quality facilities.

The residential complex has pleasant communal areas including gardens, swimming pool and gymnasium.

has been designed to adapt to your every need. It offers 2, 3 and 4 bedroom homes where design and comfort fuse to create a highly attractive property.

We offer a high level of quality in their finishes, with a practical and modern layout optimizing maximum use of space, without losing aesthetics and style. Large and luminous living and dining rooms that connect and are complemented by spacious balconies. Open-plan kitchens, fully equipped with low-consumption appliances, in accordance with criteria of sustainability, practicality and comfort.

Located near the golf courses, including the Casares Costa Golf complex, where the spectacular Finca Cortesín Golf & SPA is located, next to the development, which retains its title as the best golf resort in Europe.

- | | | |
|---|---|---|
|  2 bedrooms |  2 bathrooms |  99m ² Build size |
| <input checked="" type="checkbox"/> Swimming Pool | <input checked="" type="checkbox"/> South-west orientation | <input checked="" type="checkbox"/> 14 m ² terrace |
| <input checked="" type="checkbox"/> Communal garage | <input checked="" type="checkbox"/> Communal garden | <input checked="" type="checkbox"/> Communal pool |
| <input checked="" type="checkbox"/> Air conditioning | <input checked="" type="checkbox"/> Fully fitted kitchen | <input checked="" type="checkbox"/> Utility room |
| <input checked="" type="checkbox"/> Double glazing | <input checked="" type="checkbox"/> Brand new | <input checked="" type="checkbox"/> Private terrace |
| <input checked="" type="checkbox"/> Mountain view | <input checked="" type="checkbox"/> Golf view | <input checked="" type="checkbox"/> Covered terrace |
| <input checked="" type="checkbox"/> Fitted wardrobes | <input checked="" type="checkbox"/> Gated community | <input checked="" type="checkbox"/> Lift |
| <input checked="" type="checkbox"/> Garden view | <input checked="" type="checkbox"/> Pool view | <input checked="" type="checkbox"/> Panoramic view |