

2 s oveææ r | Vi ear ot agæ Ri jo ,t Aot i jr i vot i cn 1ji 3i
9. 0000€

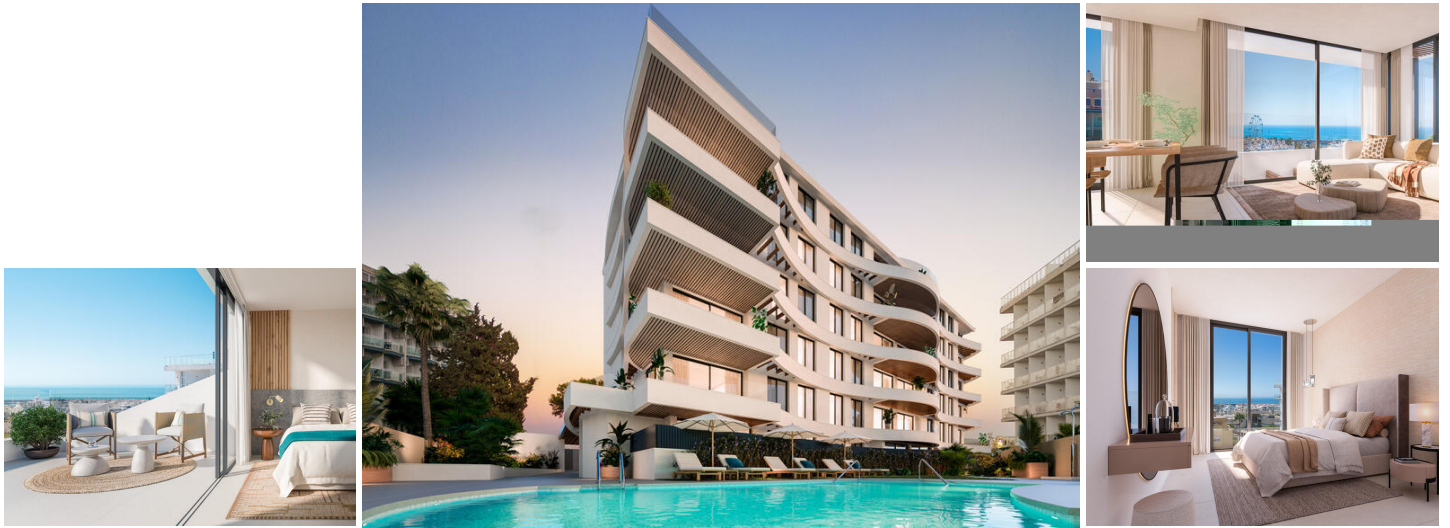

Introducing a stunning apartment in a brand new development, ideally located in a vibrant and very popular area of Benalmadena.

Situated just a short walk away from wide sandy beaches, lively promenade and a charming harbour, this apartment offers the perfect coastal living experience. There are plenty of restaurants and bars nearby, ensuring that your evenings are never boring.

There you will have comfortable life. All you need for your daily routine is reachable within a short walk. Food stores, schools, international schools, hospitals, fitness centers are in the area as well as one of the most beautiful parks. For those who love to explore, the train station is just a short distance away, providing easy access to Malaga within 30 minutes and Malaga's airport within 15 minutes.

The complex itself offers 33 units. Each unit is flooded with natural light, creating a bright and inviting atmosphere. The modern design of the apartments ensures a sleek and contemporary living experience. Residents can enjoy the fantastic common area, which includes a refreshing outdoor swimming pool. The communal areas have been thoughtfully designed to strike a balance between relaxation and privacy.

The apartment offers a spacious open-plan living room and equipped with high-quality appliances. This layout allows easy interaction and socializing while cooking or entertaining guests.

There is a large terrace accessible from every room and includes both covered and uncovered areas. It has a great size and provides plenty of room for outdoor furniture, plants, and other decor. The terrace offers a partial sea view and the picturesque Puerto Marina, providing breathtaking vistas both day and night.

On your right from the main entrance you'll find 3 ample bedrooms, with the master bedroom at the end of the hall and featuring an ensuite bathroom and a walk-in closet.

- | | | |
|---|--|--|
| <input checked="" type="checkbox"/> 3 bedrooms | <input checked="" type="checkbox"/> 2 bathrooms | <input checked="" type="checkbox"/> 107m ² Build size |
| <input checked="" type="checkbox"/> Swimming Pool | <input checked="" type="checkbox"/> South-west orientation | <input checked="" type="checkbox"/> 20 m ² terrace |
| <input checked="" type="checkbox"/> Communal garage | <input checked="" type="checkbox"/> Communal garden | <input checked="" type="checkbox"/> Communal pool |
| <input checked="" type="checkbox"/> Amenities near | <input checked="" type="checkbox"/> Transport near | <input checked="" type="checkbox"/> Air conditioning |
| <input checked="" type="checkbox"/> Central heating | <input checked="" type="checkbox"/> Storage room | <input checked="" type="checkbox"/> Double glazing |
| <input checked="" type="checkbox"/> Brand new | <input checked="" type="checkbox"/> Private terrace | <input checked="" type="checkbox"/> Beachside |
| <input checked="" type="checkbox"/> Unfurnished | <input checked="" type="checkbox"/> Close to children playground | <input checked="" type="checkbox"/> Close to sea / beach |
| <input checked="" type="checkbox"/> Uncovered terrace | <input checked="" type="checkbox"/> Close to shops | <input checked="" type="checkbox"/> Close to town |

