

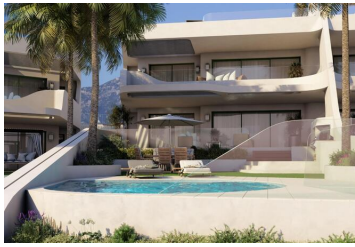



3 soverom Leilighet til salgs i Marbella, Málaga

1.295.000€



NEW BUILD RESIDENTIAL COMPLEX NEAR MARBELLA New Build an exclusive luxury complex consisting of 8 apartments with sea views in Cabopino, near Marbella, in the best area of the Costa del Sol. Its southwest orientation guarantees the best sun exposure and spectacular panoramic views, we have taken care of every detail with an innovative design, a privileged location, just 5 minutes from the spectacular dunes of Artola, for golf lovers you can enjoy the golf course of Cabo Pino. The development is only 15 minutes from Marbella town and 30 minutes from Malaga airport. Artola - Cabopino Beach is in the town of Marbella is one of the best virgin beaches you can find along the Costa del Sol. It's 1,200 metres long within the Dunas de Artola nature preserve declared a Natural Monument in 2001. This beach's landscape contains breathtaking dunes and striking indigenous vegetation that lets visitors feel free and connected to nature. With delicate, gold sand, the beach is perfect for everyone as it has areas for families with sunbeds and beach chairs for let as well as beach bars and restaurants to cool off. There is also a nude beach..

- | | | |
|--|---|--|
|  3 soverom |  2 bad |  242m ² Bygg størrelse |
|  30m ² Tomtestørrelse | <input checked="" type="checkbox"/> Garden | <input checked="" type="checkbox"/> Private pool |
| <input checked="" type="checkbox"/> Gated | <input checked="" type="checkbox"/> Solarium: Yes | <input checked="" type="checkbox"/> Views: Sea |
| <input checked="" type="checkbox"/> Air Conditioning: Pre-Installed | <input checked="" type="checkbox"/> Double Bedrooms: 3 | <input checked="" type="checkbox"/> Elevator/Lift |
| <input checked="" type="checkbox"/> Near Golf / Golf Resort Property | <input checked="" type="checkbox"/> Under-Build / Basement | <input checked="" type="checkbox"/> Location: Coastal |
| <input checked="" type="checkbox"/> Number of Parking Spaces: 2 | <input checked="" type="checkbox"/> Terrace: 40 Msq. | <input checked="" type="checkbox"/> Beach: 1200 Meters |
| <input checked="" type="checkbox"/> Useable Build Space: 190 Msq. | | |