

## 3 slaapkamer Appartement Te koop in El Verger, Alicante

**493.000€**

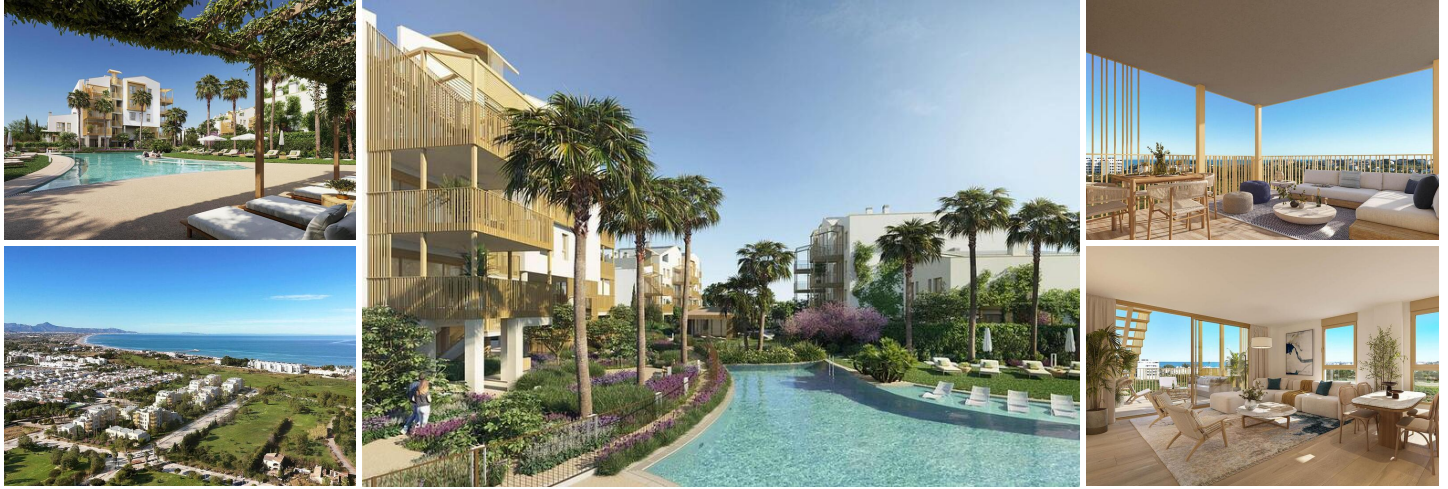

### NEW BUILD RESIDENTIAL IN EL VERGEL

New Build residential complex of 1, 2 and 3 bedrooms apartments and penthouses in El Vergel designed as compact structures a response to the architects and designers constant pursuit of efficiency in the development. These decisions, spread throughout the various key points of the residential area, ensure that your home stays at the right temperature both in winter and summer.





The main feature of the properties will be their large terraces. With regular proportions, they are the ideal spaces for outdoor living. The integration of the living room with these spacious terraces will unite your home as a livable volume where the interior merges with the exterior.

Moreover, the construction in the area is planned to have minimal impact. The careful selection of construction materials has allowed you to enjoy the extraordinary views offered by the natural environment of residential complex permanently.

Properties organized around a living room open to a terrace-bedroom. Live inside and outside the house.

The common areas of this complex embody a deeply natural spirit. As you walk through different areas, you'll find ideal spaces for strolling, engaging in sports activities, and, above all, using bicycles.

Gather with your partner, family, or friends at the social clubs; enjoy open squares protected from the sun and unwind in cool spots where vegetation thrives and air constantly circulates.

- |   |   |   |
|---|---|---|
|  3 slaapkamers                    |  3 badkamers |  112m <sup>2</sup> Bouwgrootte |
|  126m <sup>2</sup> Perceelgrootte | <input checked="" type="checkbox"/> Zwembad   | <input checked="" type="checkbox"/> Communal Pool   |
| <input checked="" type="checkbox"/> Gym   | <input checked="" type="checkbox"/> Garden  | <input checked="" type="checkbox"/> gated   |
| <input checked="" type="checkbox"/> Number of Parking Spaces: 1   | <input checked="" type="checkbox"/> Near Schools  | <input checked="" type="checkbox"/> Double Bedrooms: 3  |
| <input checked="" type="checkbox"/> Near Commercial Center  | <input checked="" type="checkbox"/> Location: Coastal, Urbanisation                             | <input checked="" type="checkbox"/> Near Childrens Parks  |
| <input checked="" type="checkbox"/> Elevator/Lift   | <input checked="" type="checkbox"/> Air Conditioning: Yes                                       | <input checked="" type="checkbox"/> Useable Build Space: 90 Msq.  |
| <input checked="" type="checkbox"/> Terrace: 68 Msq.  | <input checked="" type="checkbox"/> Beach: 400 Meters   | <input checked="" type="checkbox"/> B   |