

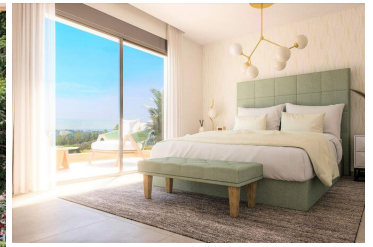

2 Schlafzimmer Appartement zu verkaufen in Atalaya, Málaga

720.000€

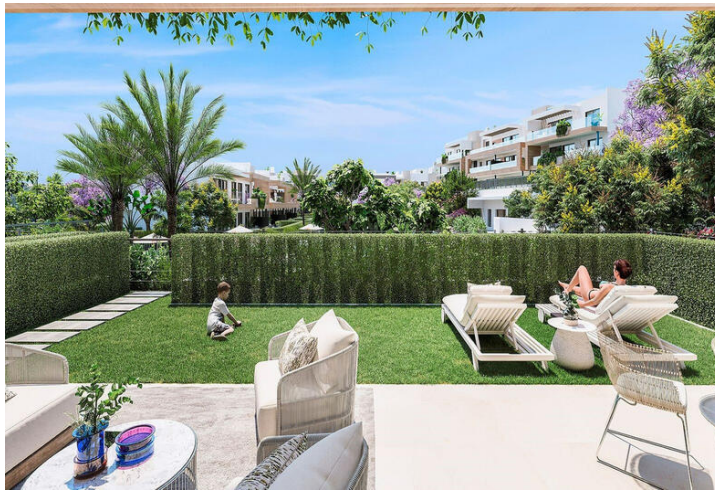

****Key Ready Last 3 units available**** Amazing new development on the Benahavis road close to Shops, bars, supermarkets and golf. Stunning contemporary design with floor to ceiling patio doors, open plan fully fitted kitchen, Quality fittings throughout, Under floor heating, Private parking and Store room. Special attention has been given to the communal areas in this development with a large adult pool, Heated pool, Childrens pool and even a Lake. The communal areas will be finished as an ideal place to relax and enjoy those hot summer days. A childrens play area and special water jets are also included in the communal area specially for families. The development has its own onsite fully equipped gymnasium solely for the use of residents. The complex is being constructed by one of Spain's leading developers with a reputation for delivering outstanding qualities and exceeding expectations. Location is always important and this development doesn't disappoint. The picturesque village of Benajavis is only 10 minutes by car as are both Puerto Banus and Estepona. Atalaya golf is just around the corner for golf lovers and the beaches of the New golden mile can be reached in around 5 minutes. Also available 3 beds from €767,000



2 Schlafzimmer



85m² Grundstücksgröße



Category - Holiday Homes



Category - Off Plan



Condition - Excellent



Features - Ensuite Bathroom



Features - Gym



Features - Near Transport



2 Badezimmer



Schwimmbad



Category - Investment



Climate Control - Air Conditioning



Condition - New Construction



Features - Fiber Optic



Features - Jacuzzi



Features - Private Terrace



92m² Baugröße



Category - Contemporary



Category - Luxury



Climate Control - U/F Heating



Features - Double Glazing



Features - Fitted Wardrobes



Features - Lift



Features - Storage Room



Immobilien vermarktet von España Dream Properties

www.spainpropertyportal.com/de/